



INSTRUCTIONS FOR ADJUSTING THE STOP PIN IN A MODEL 431 SHOPPERTRON

SOLENOID POSITION ADJUSTMENT

1. Turn the machine power switch OFF
2. Remove the solenoid cover plate screws (2) and the cover plate (4).
3. Locate the two adjusting screws in the slotted holes to the right of the solenoid. Loosen, but **DO NOT REMOVE** the adjusting screws.
4. Pull the stop pin down and rotate the drum by hand so the pin rides on the bottom of the drum stop plates.
5. Place a .078 thick shim (or use approximately one to two dimes) under the plunger of the solenoid as shown.
6. Push up on the bottom of the solenoid to raise the assembly to the working position. Tighten the two adjusting screws.
7. Rotate the drum by hand until the stop pin seats into a hole. Remove the shim(s).
 - a. Turn the machine power switch ON.
9. Test run the drum rotation and locating stop features. If needed, the stop switch can be adjusted for proper engagement.
10. Install the solenoid cover plate to the front of the assembly and secure with two screws.

If necessary, perform the following procedure:

STOP SWITCH ADJUSTMENT

1. Remove electrical power from the machine.
2. Remove the stop pin assembly (1) from your machine.
3. Remove the cover and loosen both stop switch mounting screws.
4. Unhook one end of the spring.
5. Rotate the stop delay cam until the switch roller ride on the cam high point just below the cam dimple.
6. ~~Rotate the~~ **NYLON ARM AGAINST THE TOP OF THE BOX.** Rotate the switch until the switch roller bracket just bottoms out on the switch housing.
7. Tighten the switch mounting screws.
 - a. Replace the spring.
9. Replace the stop pin assembly (1) in the machine. Be sure the harness (3) is properly connected.
10. Restore electrical power to the machine and verify that the turret can find its home position.
12. Perform the solenoid position adjustment procedure again, if necessary, to ensure proper stop pin operation.

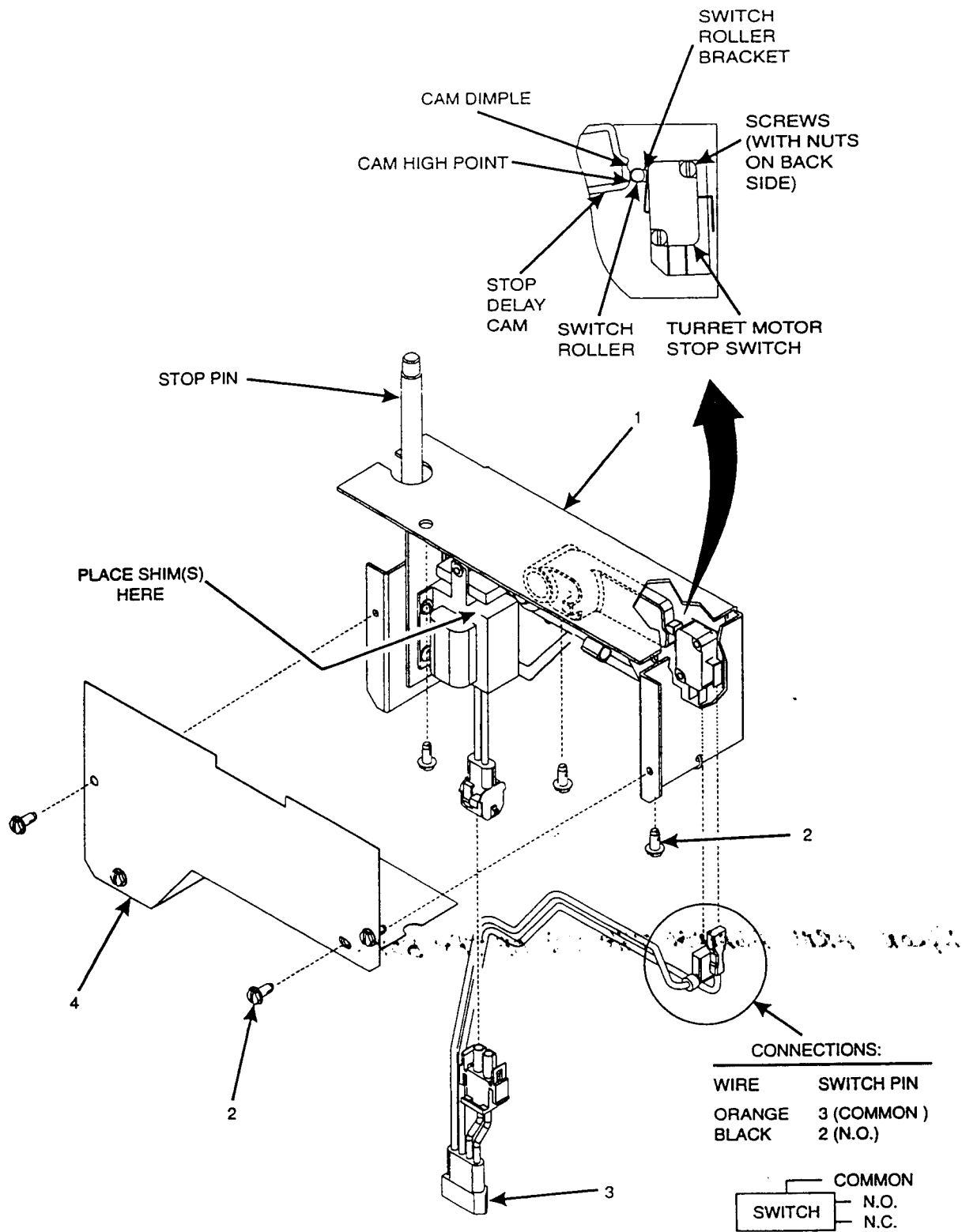

Figure 1